



**THE GREENWAY CURRENT**  
**THE GREENWAY FOUNDATION ANNUAL REPORT**  
**2015**







The Greenway  
Foundation  
1855 S. Pearl St.  
Suite 40  
Denver, CO 80210

[www.greenwayfoundation.org](http://www.greenwayfoundation.org)

Thank you Tom Rice Photography  
and Karen Keyes for your  
contributions to the photography in  
this publication.

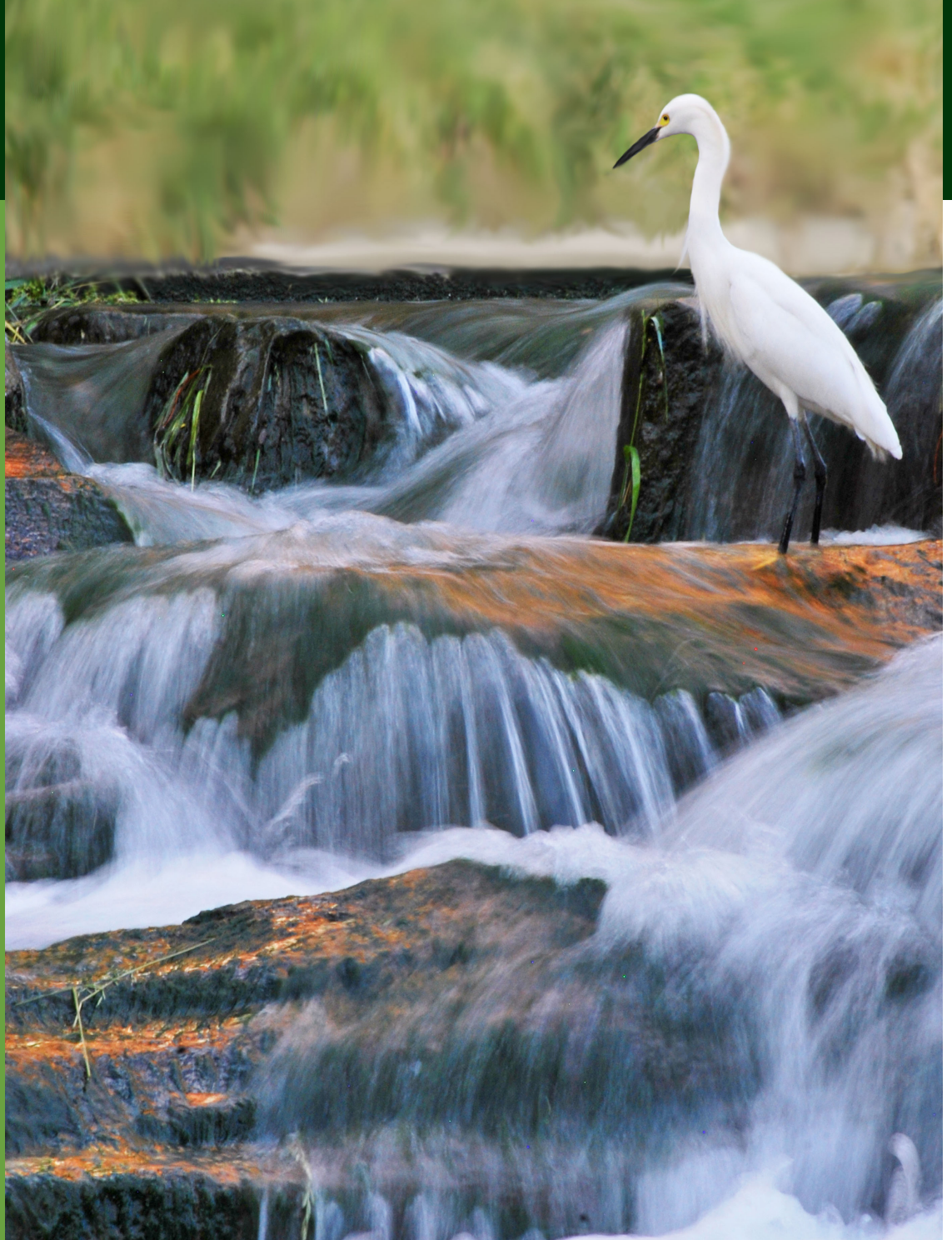



# From the Chairman of the Board

It is amazing how time flies and things change.

Over the last four decades, The Greenway Foundation (TGF) has evolved and expanded from a Foundation that predominantly built trails, parks and boat chutes to a multi-faceted non-profit organization that is also involved with water storage and delivery, water quality enhancements, ecosystem restoration and flood control enhancements as well as programming efforts that teach all of our fellow metro Denver citizens, ages 5-95, about the importance of appreciating and championing these invaluable urban waterways.

TGF's forty-one year mission to preserve, protect, enhance and engage these vital amenities has never been more important. In addition to its work along the South Platte River watershed, TGF is now engaged with municipalities beyond metro Denver and the state of Colorado, guiding and assisting their respective efforts to improve their streams and rivers, using the experiences, successes and challenges of TGF.

TGF's incredible Staff provide numerous opportunities for young people to spend time on the South Platte River and Cherry Creek as they engage in the various programs of the Foundation's educational arm, SPREE (South Platte River Environmental Education). These students learn why they are important to the future sustainability of the South Platte River and its tributaries, as well as waterways throughout Colorado.



Many of the students who spend time on the River come away with a new appreciation for ecology, water use and preservation, as well as a desire to teach what they have learned to others.

As the Chairman of TGF's Board of Directors, it is a very rewarding feeling for all of us on the TGF Board to have these young people, who occasionally come into our programs carrying a degree of indifference, leave with a better understanding of what being part of this world means and being willing to assume the responsibility of sharing these lessons with their peers.

As we look forward to 2016, The Greenway Foundation's Board and Staff continue to strive to maximize our efforts to, in turn, maximize our local environment and the related education and engagement of those who will be in charge of its future. It is an honor for all of us to be a part of this ongoing, innovative and active endeavor.

Please take a moment to look through this year's Annual Report and join us in our excitement for "what's next!"

Kip Stastny  
Chairman of the Board  
The Greenway Foundation





## About the Foundation

Since 1974, The Greenway Foundation has led the effort to reclaim the South Platte River and its tributaries from a virtual cesspool to a place of environmental and recreational pride.

The mission of The Greenway Foundation is to advance the South Platte River and the surrounding tributaries as a unique environmental, recreational, cultural, scientific and historical amenity that uniquely links our City's past with its future.

### **This mission is accomplished by:**

- Creating ongoing environmental and riparian enhancements
- Holding property, when needed, in conservation easements
- Utilizing the River as an outdoor and historical learning resource
- Hosting free cultural events promoting the relationship between the River and music, art and theatre
- Providing youth employment opportunities through the Greenway River Ranger program
- Promoting good stewardship through our hands-on South Platte River Environmental Education (SPREE) programs



250+

Sources of pollution  
eliminated from entering  
into the South Platte River



1,200+

Hours of environmental  
education taught each year



100,000+

Linear feet of water quality,  
recreational, environmental,  
and flood control  
improvements

\$500 Million of green  
improvements to the South  
Platte River and its tributaries,  
facilitating over  
\$20 Billion in residential,  
retail, commercial, and  
entertainment development  
throughout the Denver area

1,800

Hours of paid youth  
employment during  
The Greenway Foundation  
Summer Camps

100+

Acres of parks and natural  
area and 100+ miles of  
multi-use recreation trails  
along the South Platte  
River Greenway and its  
tributaries







## The Flood of 1965

Fifty years ago, on June 16th, 1965 a storm gathered over Denver and an intense rain began to fall. The water levels of the long-polluted South Platte River began to swell and break forth from its banks. The River swept out into the city creating the largest natural disaster in Denver's history. The flood inundated 250,000 acres of land and caused \$540 Million in damages, equating to over \$14 Billion in today's dollars.

---

**“Instead of the normal 300 cubic feet of water per second, or the 3,000 that we called exceptionally high..., the raging South Platte hit us with the astonishing flow of 150,000 cubic feet per second”**  
*(Returning the Platte to the People, Joe Shoemaker, 1981).*

---



For nine years, the South Platte River continued to lay in waste. The River was ecologically dead, and it was said that you could hear the water flow but not see it through all of the trash. In 1974, Mayor Bill McNichols and State Senator Joe Shoemaker co-founded the Platte River Development Committee (PRDC) with Senator Shoemaker as the Chair. Charged with initializing the revitalization of the South Platte, the PRDC, which two years later became The Greenway Foundation, took on the monumental task of breathing life into a dead urban waterway.



Since then, over \$500 Million has been invested into the River, and its parks and trails, allowing the River to evolve from a virtually abandoned and forgotten open sewer to the vibrant, healthy, enhanced and engaged urban waterway that it is today. Over 100,000 linear feet of water quality, recreational, environmental and flood control improvements, over 100 acres of parks and natural areas, and over 100 miles of multi-use recreation trails have been added to the South Platte River Greenway and its tributaries. This investment is directly connected to the realization of over \$20 Billion in related economic benefits to metro Denver and its citizenry.

Today, Denver's urban waterways are a destination spot. On any given day, you will find people cooling their feet in the water, bicyclists zooming along the trail, or fishermen waist deep in a significantly revitalized River. The flood of 1965 was Denver's largest natural disaster, but from this turmoil blossomed an ongoing mission to allow Denver's greatest natural resource, the South Platte River watershed, to once again be recognized as our city's greatest, and most valued amenity.



**“By the time the flood was in the center of the city it had damaged every bridge in its path and the tide was gathering an increasing load of debris: trees, buildings, entire mobile homes, telephone poles trailing wires, an armada of old and new automobile tires, operable and junked cars, entire lumber yards, fences, tanks loaded with Lord knew what.”**

*(Returning the Platte to the People, Joe Shoemaker, 1981).*



# RVIP

## River Vision Implementation Plan Projects

By Michael Bouchard, Denver Parks and Recreation

Over the last eight years, The Greenway Foundation has partnered with numerous public and private entities to collaboratively create a significant visioning, design, funding and, now, construction endeavor. When completed, the project will provide over \$30 Million of new recreational, environmental, water quality and flood control improvements to five areas of Denver's South Platte River Greenway.

These transformational projects involve the engagement and support from 19 partners at all levels of the public and private sectors.

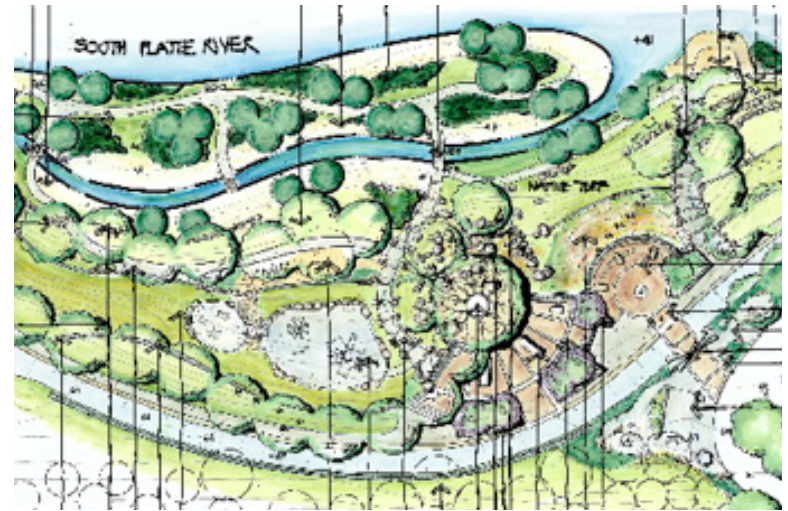
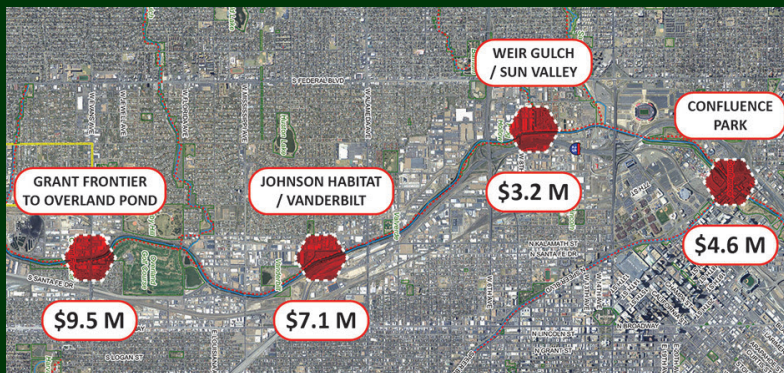

## Grant Frontier Park

Construction Budget: \$3,675,000

Construction Schedule: Fall 2015 – Fall 2016

Grant Frontier Park weaves together riparian restoration, regional trail enhancements, environmental education and nature play and then adds an additional layer of cultural history to the mix. A series of terraces step up the slope, each marking a flood level of the South Platte River so that the structure of the park itself expresses and reveals the seasonal hydrology of the River. The top terrace is the most refined and includes an overlook and community gathering space anchored by an existing 100 year old cottonwood. The second terrace includes an extensive natural play area. Paying homage to the first platted settlement along the Front Range, the Montana City interpretive area honors the pioneers who first settled the banks of the River in 1858, and will include a wagon, scale cabin structure and a variety of educational elements.



## Pasquinel's Landing

Construction Budget: \$1,655,000  
Construction Schedule: Spring 2015 – Fall 2015

The River Vision Plan transforms this 35 year old park area into a new type of park - a hybrid of natural systems, modern recreation and neighborhood gathering spaces. The design of Pasquinel's Landing literally brings the South Platte into the park. The regional trail is pushed away from the River in a graceful arc, and the space between is scooped out like a bowl. A secondary channel carves into the bowl, creating a gravel bar island at the River's edge. A simple swath of turf rolls down toward the island, providing flexible space to recreate or just relax. ADA accessible trails frame the lawn and cross the secondary channel, making the island a destination that is inviting to everyone. An adult fitness zone and future natural play area round out the design on the neighborhood side of the park.



## Florida Drop Structure

Construction Budget: \$3,630,000  
Construction Schedule: Fall 2014 – Summer 2015

The existing 8' drop structure south of the Florida Ave bridge backed up water for over a mile upstream along Overland Golf Course, creating shallow and slow-moving stretch of river – one of the most ecologically barren stretches of the entire urban watershed. The 8' drop structure was demolished and a smaller 3' multi-purpose structure built in its place. The new structure includes a boat chute with a standing wave for skills training and recreation. Tying the riffles and drop structures together is a low-flow channel defined by extensive new wetland benches. The low-flow channel creates deeper, cooler water even during the driest parts of the year and the revegetated wetland benches provide additional shade and riparian habitat. When mature, this previously barren stretch of river will be transformed into one of its most vibrant treasures.





## Weir Gulch

Construction Budget: \$3,600,000  
Construction Schedule: Winter 2014 – Fall 2014

The confluence of Weir Gulch and the South Platte River occurs in the Sun Valley Neighborhood, a lowland area out of sight and, too often, out of mind for most Denver residents. In 2011, this site was identified as the initial project within the River Vision Implementation Plan to be completed. The design creates a new connection of the Gulch to the River by daylighting the Gulch, allowing it to traverse over a new boulder waterfall and into a receiving pool flanked by a sculpted concrete jetty. The pool allows sediment to settle out before reaching the River, and the jetty provides clean, ADA-accessible access to the River. An improved regional trail now crosses over the Gulch via a new signature bicycle and pedestrian bridge, celebrating this restored amenity, and allowing it to receive the respect it has long deserved.

## Confluence Park

Construction Budget: \$4,250,000  
Construction Schedule: Spring 2015 – Winter 2017

The confluence of the South Platte River and Cherry Creek was the original birthplace of the City and County of Denver back in 1859. In 1975, Denver and The Greenway Foundation (TGF) created the initial version of a variety of improvements to this area, renaming the site Confluence Park, which quickly became the epicenter for the rebirth and reclamation of Denver's most important waterway.

In 2012, Denver, TGF and the Urban Drainage and Flood Control District began an ambitious master planning process to bring Denver's birthplace into the 21st century. The Confluence Park Master Plan is a \$50 million vision to unite the three areas of the park, reduce conflicts between pedestrians and bicyclists and create a series of spaces for people to gather and celebrate the River.

In Spring 2015, Denver began implementation of Phase 1 of the Master Plan - the redesign and reconstruction of Shoemaker Plaza on the west side of the River below REI as well as the ramp system leading to the Plaza. When complete, the project will realign the regional bike trail and create a series of concrete terraces to reconnect Denver's citizens to their city's birthplace. The project is expected to be complete by early 2017.







# Johnson Habitat Park

Construction Budget: \$5,350,000

Construction Schedule: Spring 2014 – Summer 2015

Johnson Habitat Park (JHP) is the flagship park of the River Vision Implementation Plan (RVIP) projects. The design transformed eight acres of un-programmed grassland into Denver's premier environmental education and nature play park.

Like many sites along the River, JHP was originally mined for sand and gravel. Later, the empty gravel pits were filled with municipal trash and construction debris, then covered with dirt and seeded with grasses. One of the goals of RVIP is to increase access to the River. In the case of JHP, this goal required the removal of over 1,200 dump truck loads of dirt, trash and debris, at a cost of over \$1 million. Repairing the damage to our River is a costly process, but it is money well spent!

This massive excavation set the stage for a uniquely creative and dynamic park. The design includes a series of nature play and environmental education areas arrayed around a central open lawn: an urban camping area with 12' high boulders; climbing nets; an outdoor classroom area; an interactive wiki-up zone and an amphitheater and fire pit along a jetty adjacent to the banks of the River. TGF's SPREE (South Platte River Environmental Education) program is headquartered within JHP, so there are always lots of kids catching crawdads and learning about river ecology!







## Camping with SPREE



Johnson Habitat Park is not only Denver's premier environmental education park, it is also the only park that allows our city's youngsters and their families to camp overnight within city limits at a SPREE program. TGF's SPREE team offers young people and their families the opportunity to pitch a tent, cook over an open fire and attempt to catch a trout within the River, right in the very heart of Denver.

As part of June's Great Outdoors Month, The Greenway Foundation, Get Outdoors Coalition Colorado, and the USDA Forest Service teamed up with The Coleman Company, Denver's Department of Parks and Recreation, and Albertsons to create an unforgettable night under the stars for 20 urban youth from the nearby Sun Valley Neighborhood. These youngsters and their families experienced a campfire, s'mores, music, stories and songs. Everyone came away from the evening with the introduction they need to continue a lifetime of enjoying the outdoors and sharing that love with family and friends.





“Students loved the experience and came back saying it was their favorite field trip. The activities align with second grade science units.”

– Gust 2nd grade teacher

“I had so much fun. My brain was pop, pop, pop, and pop. I was learning super awesome.”

– 4th grader at Teller

## Environmental Education Elementary School Field Trips

SPREE Excursions provide opportunities for children to discover “nature in their own back yard.” These field trips take place in seven different riverside parks throughout Denver and teach students science, history, and stewardship skills through hands-on games, exploration and investigation. For many children, these excursions provide their first experience to catch a crawdad, enjoy a raft trip, or even view and experience the South Platte River!

### 2015 Results:

- Two new SPREE Schools, for a total of thirteen (Cory, Fairview, Farrell B. Howell, Grant Ranch, Gust, Joe Shoemaker, McKinley-Thatcher, Montclair, Palmer, Polaris at Ebert, Southmoor, Steele, Teller)
- Twenty-seven schools participated in SPREE Excursions, the vast majority of which represent a highly diverse and underserved population of students
- By adding a single new staff member, SPREE was able to take an additional 1,000 students on excursions this school year, for a total of 4,950 students
- 121 excursions equaling over 600 hours of education along the River
- Over 90% of 5th graders attending SPREE Schools demonstrated a high level of environmental literacy

In 2016, SPREE is looking forward to bringing over 5,000 children “down to the River” on SPREE excursions and continuing to expand options for in-class activities that complement the field trip curriculum.

# Joe Shoemaker School

## By Brent Applebaum

**“This school is wonderful because every single teacher is amazing and every day is challenging. It’s wonderful to be a part of this amazing school because our school is unique.”**

**-5th grader at Joe Shoemaker**

On September 22nd, 2015, Joe Shoemaker School (JSS) was officially dedicated in honor of the Founder of both The Greenway Foundation and the Colorado Parks Foundation. JSS was built as an Early Childhood Education through fifth grade elementary school, located along the Cherry Creek Greenway in the Hampden Heights neighborhood in southeast Denver.

In January 2014, a modest, albeit dedicated group of individuals came together to imagine what their dream school could be. For several months, this group worked late nights and weekends to write a school proposal for what has now become JSS – a place of learning and discovery that is more than standards and accountability – a school that is about cultivating the inherent curiosities and talents in children. JSS focuses on ensuring that our youngest learners are empowered as citizens and ready to create a future that we can only imagine. Joe Shoemaker knew that his vision of revitalizing and sustaining Denver’s urban waterways would require the skills and dedication of future generations. JSS is a living example of that vision. The Greenway Foundation would like to acknowledge the talents, passion and energy of the following individuals, without whom, Joe Shoemaker School would not be a reality: Brent Applebaum, Jolon Clark, Chris Fleming, Laurie Godwin, Jon Mann, Carrie Moore, Donny Roush, and Sue Sava.

In addition to being the newest SPREE School, JSS will be the site of The Greenway Foundation’s third summer camp location.





# Greenway River Rangers & Greenway Leadership Corps

## Greenway River Rangers

The Greenway River Ranger Program (Program) is designed for high school students to explore possibilities in the environmental field through training, hands-on teaching experience, and outdoor adventure. Students develop leadership, communication, and critical thinking skills that will serve as powerful tools for their future. Included within the Program is an internship component wherein 10 students are trained as environmental educators and gain teaching experience involving SPREE's 5th grade field trip. Subsequently, the outstanding students who have experienced the River Ranger internship program are hired to work for The Greenway Foundation as environmental educators at SPREE's summer camp program. At the end of the Program:

- **100% of Rangers were able to correctly answer questions on the local environment**
- **100% increased their knowledge of local environmental issues**
- **100% of the Rangers expressed a desire to pursue college courses about the environment**

## Greenway Leadership Corps

Each year, SPREE's Greenway Leadership Corps (GLC) program builds a network of over 100 high school-aged students throughout the Denver area who are interested in building leadership skills and doing volunteer work to help the environment.

In 2016, SPREE plans to increase the reach of the GLC program by continuing to reach out to students throughout Denver and joining with new partner organizations to expand the program's impact. SPREE also plans on having smaller-scale custom GLC events to maximize the needs of the growing consortium of partners.



"I was excited for this trip because in the future I want to become a civil engineer and specialize in something to do with the environment. Therefore this trip gave me a new look at the environment I am living in, additionally teaching me more about a field in which I wish to become a professional in the future."

-Berenice, River Ranger



# Day Camps along the River & Junior River Rangers

## Adventures Outside Day Camps

SPREE's award-winning Adventures Outside Day Camps offer fun, adventure-filled urban environmental education opportunities over eleven uniquely themed weeks each summer as well as numerous days within the school year. During 2015, these unique and increasingly popular camps were held at two spectacular riverside locations: the newly-remodeled Johnson Habitat Park and the Cherry Creek Train at Speer Boulevard Park. SPREE is excited to have a third location in 2016 for its summer camp program at Joe Shoemaker School.

This past year, over 900 students attended SPREE's camps along the South Platte River and Cherry Creek. Campers were water engineers, environmental detectives, outdoor adventurers and even mural artists! SPREE also hosted its second annual urban campout in Johnson Habitat Park. This impactful event allowed campers and their families to enjoy an overnight campout with "nature in their own backyard!"



## Junior River Rangers

Junior River Rangers is SPREE's newest program! Over the summer, 6th through 9th grade students enjoyed being helpers and young leaders as part of SPREE's summer camp. Thirteen Junior River Rangers served as support staff for a total of 630 hours of youth enrichment. In 2016 a third summer camp location will allow for a total of twenty Junior River Ranger positions to be offered to deserving young people.

"...the reports we got from him and the SPREE staff at HQ all point to a summer of learning and growth – especially as they relate to him taking on the role of Junior Ranger. It was a fantastic opportunity for him, and I want to thank you... for all your work in pulling this together and creating this great pathway to more experience and responsibility within SPREE!"

-Parent of a Junior River Ranger



# Friends of Greenway

Friends of Greenway (FOG) is The Greenway Foundation's (TGF) monthly recurring donation program. For as little as \$5 a month, anyone can help support TGF's mission to "Revitalize Rivers and Reconnect Communities."

Each and every donation allows TGF to continue to improve our urban waterways along with its adjacent parks and trails as well as provide youth education and youth employment throughout the year.

No amount is too small and 100% of your donation goes into the dedicated FOG Fund so that your donation can provide support to TGF on an ongoing basis.

Make your donation today:  
[www.greenwayfoundation.org/donate](http://www.greenwayfoundation.org/donate)







## Ways to Make an Impact

Your financial support allows The Greenway Foundation's initiatives to be increasingly accessible to countless fellow metro Denver citizens regardless of their financial situation. Every donation allows TGF's programs to be fully inclusive, providing experiences for those who might not otherwise get to participate.

### Consider supporting the FOG Fund by:

- Becoming a **Friend of Greenway** by making a monthly or annual contribution either online or with the attached envelope
- Including The Greenway Foundation in your will or estate planning
- Attending TGF's signature benefit events - Gala on the Bridge and After Party on the Bridge

**\$10/year or ~\$0.80/month**

Sends a student on a unique Riverside field trip

**\$50/year or ~\$4/month**

Supports the ongoing reclamation of the South Platte River Watershed

**\$100/year or ~\$8/month**

Gives a deserving student a scholarship to attend camp

**\$250/year or ~\$20/month**

Sends an entire class on a grade-specific field trip

**\$500/year or ~\$40/month**

Ensures the future of TGF's ability to restore rivers and reconnect communities

**\$1,000/year or ~\$80/month**

Provides one month's wages for a high school educator

You can learn more about ways to give and opportunities to get involved on TGF's website at [www.greenwayfoundation.org](http://www.greenwayfoundation.org)



# Spring and Fall RiverSweeps



On April 25, 2015 over 600 volunteers participated in the CH2M Spring RiverSweep presented by MillerCoors and The Nature Conservancy. Volunteers worked with Denver Parks and Recreation to prepare the South Platte River Greenway to be ready for the active summer use it enjoys each year.

On September 26, 2015 over 150 volunteers again gathered at Fishback Landing Park in Downtown Denver for the Fall RiverSweep presented by CH2M, MillerCoors and The Nature Conservancy.

At each of these events, volunteers joined forces to help with numerous improvement, repair and enhancement-based projects including trash removal, crusher-fine based trail construction, graffiti removal, tree protection, willow harvesting or relocation and more.

## Impacts:

- Over 750 volunteers participated
  - Over 1,500 hours dedicated to local parks
  - Three miles of the River positively impacted
  - Eight different parks enhanced
  - 72 cubic yards of mulch installed
  - 44 linear yards of crusher-fine trails installed
  - 20 yards of plant debris cleared
  - 686 trees and other vegetation planted
  - Significant areas of graffiti removed or covered
  - Originative volunteers separate 1200 pounds of trash
- 381 pounds of debris were diverted from landfills
- |                             |                   |
|-----------------------------|-------------------|
| Plastic bottles: 115 pounds | Paper: 70 pounds  |
| Glass: 58 pounds            | Metals: 45 pounds |
| Clothing: 62 pounds         | Misc: 31 pounds   |

# Coors Light South Platte RiverFest

On June 27 and 28, 2015 the Coors Light South Platte RiverFest returned for the 3rd year, bringing over 20,000 individuals to the South Platte River to explore the wide variety of family-friendly recreational opportunities along its banks, trails, parks and waterway. This free festival celebrates the South Platte River watershed as well as the numerous residents and businesses living, working and playing along this local riparian treasure. The Coors Light South Platte RiverFest is the premier river festival in Denver, featuring food and beer vendors, standup paddleboard (SUP) demonstrations, and sport gear retailers. This fun festival also creates an awareness and an appreciation for the urban waterways within our community.

Although the high water levels this past summer prevented the event from taking place directly on the River, over 2,000 people were still able to try out free SUP boarding and rock climbing lessons. In addition to the adventure activities, attendees enjoyed live music, fitness classes, kid zones, slack lining and an art competition focused on celebrating the River.

- 20,000 attendants
- 2,000 SUP and rock climbing participants
- 23 retail vendors
- 10 food vendors
- 12,000 beers sold (Attendees voted for how funds raised through beer sales at the event should be spent. "Building River Parks and Trails" received the most votes.)
- 8 bands & 2 DJs (16 hours of musical performances)
- 2,000 aluminum cans were transformed into a fish sculpture created by Originateve







## Noble Energy Gala on the Bridge

---

**“There’s no other event like  
this in Denver”**

-Gala attendee

---

The Noble Energy Gala on the Bridge is The Greenway Foundation’s signature fundraising event, held each year on the historic 19th Street Bridge. This special evening is one of a kind, offering stunning views of the South Platte River while also providing live music, cocktails, and dinner - all to support The Greenway Foundation.

With over 400 people in attendance, this year’s Noble Energy on the Bridge was the most successful event to date! The evening raised over \$125,000 for The Greenway Foundation’s mission to continue to reclaim our River and reconnect our community to their greatest natural resource.

This year The Greenway Foundation awarded the 2015 Friend of the River Award to MillerCoors for being a leading force in water conservation in Colorado, by adopting best sustainable water practices everywhere from forests, farms and breweries to supporting The Greenway Foundation’s efforts to maximize the environmental and recreational health of the South Platte River watershed.

# Blue Moon After Party on the Bridge presented by Uber

The Blue Moon After Party on the Bridge, presented by Uber, is another annual celebration on the 19th Street Historic Bridge in downtown Denver. This event is focused on introducing and engaging with today's up-and-coming civic leaders in The Greenway Foundation's ongoing efforts to reclaim, enhance and preserve Denver's urban waterways.

This year's After Party was The Greenway Foundation's most successful event to date. With over 600 attendees, the 2015 Blue Moon After Party on the Bridge offered live music, DJ's, cocktails, silent disco, silent auction and non-stop fun. A stellar music lineup included DJ sets by Eric David, Chuck Lepley, and Rose Quartz, and a live performance by Jamestown Revival!

Each year After Party on the Bridge recognizes local efforts to improve our community and the South Platte River through our Partners in Change Awards.

2015 Award Winners include:

Private Development: Medici Communities

Public Projects: Denver Trout Unlimited

Art: RedLine

Programming: Bike to Work Day

Legacy Award: Jim Karagas, My Brother's Bar

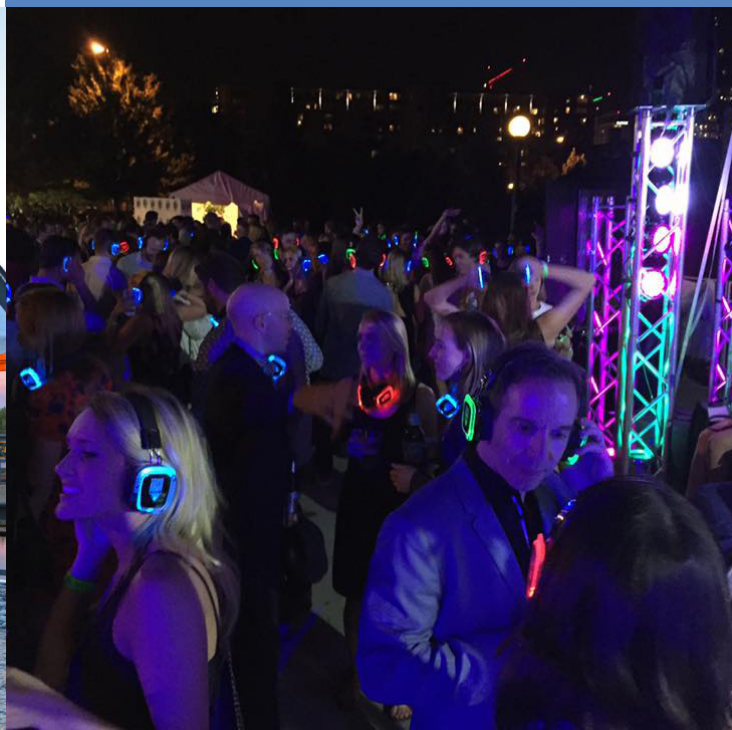



# CDM Smith Reception on the River presented by MillerCoors and ECI Site Construction

The CDM Smith Reception on the River, presented by MillerCoors and ECI Site Construction, is an annual celebration of The Greenway Foundation's ongoing efforts to reclaim, enhance and preserve Denver's urban waterways. Leaders in the business, political, environmental and water communities attend each year to discuss the ongoing challenges and opportunities that face metro Denver's greatest natural resource.

Noted civic leaders attend as guest speakers to give their perspective on the significance of the South Platte River and its tributaries. This year Mayor Michael Hancock addressed the numerous attendees. United States Senator Michael Bennet was this year's Keynote Speaker.

The 2015 CDM Smith Reception on the River was hosted at Centennial Gardens Park adjacent to Elitch Gardens and attendees enjoyed the unveiling of a completed fish sculpture art piece, created at the Coors Light South Platte RiverFest by Originateve. This unique work of art was created out of repurposed beer cans from RiverFest.

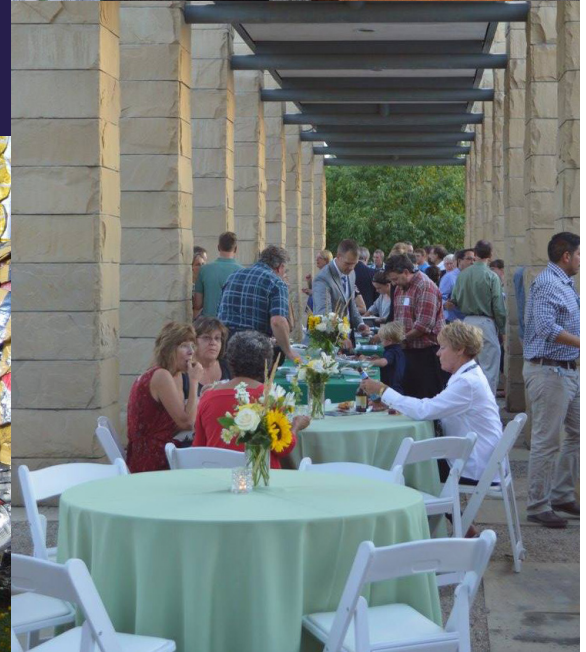



# Family Weekend Events

The Greenway Foundation's South Platte River Environmental Education (SPREE) program offered three family events this year, all of which were free to all attendees. Over 100 families participated in Art on the River, Panning on the Platte and Family Fishing Day, each of which offered activities and games that taught important information about the South Platte River and its significance to the history and future of our city.

## Art on the River

On Saturday, October 3rd, 2015 young people and their families joined SPREE at City of Cuernavaca Park. Participants created river and nature-inspired art projects, including miniature boats with the help of Originateve, as well as nature collages and leaf prints. All those in attendance also enjoyed a nature scavenger hunt.

## Panning on the Platte

On Saturday, October 17th, 2015 participants joined together at the recently dedicated Johnson Habitat

Park to prospect for gold, learn how to weave, create silly historic costumes and enjoy lunch. Each child got to take home any gold they found!

## Family Fishing Day and Water Festival

On Saturday, November 7th, 2015 over 100 children and their families joined SPREE at Overland Pond Park for a day of fishing and fun. With the help of Environmental Learning for Kids (ELK), Denver Parks and Recreation, and Earth Force - each child learned proper fishing skills and sportsman etiquette, how to care for their River, and was presented with a fishing pole that they were able to take home. Families learned about other creatures who live in the water including crawdads, and a variety of other macroinvertebrates.

## 2015 Impacts:

- Over 100 families participated
- Over 100 fishing poles gifted
- Three FREE events hosted
- Three days of environmental education for families



Register for these events  
and more at  
[www.greenwayfoundation.org](http://www.greenwayfoundation.org)



# Chatfield Reallocation Project

## By Capitol Representatives

The Chatfield Reservoir Reallocation Project made significant progress during 2015. The legal and procedural documents to allow for this generational opportunity to create critically needed water storage in Chatfield Reservoir, as well as related opportunities to allow for increased streamflow throughout the South Platte River within the 30+ miles of the River throughout the metro Denver area are finally in place!

The initial and ongoing cooperative and collaborative partnership between all engaged parties – local, regional, state, federal and non-profit – not only remains but continues to grow in its shared commitment to ensure that this exceptional project maximizes this rare opportunity to provide multiple benefits to all parties affected by Chatfield Reservoir and Chatfield State Park.

### Next steps include:

- Design and construction of recreational improvements and environmental mitigation projects within Chatfield Reservoir
- Ensuring the needed engagement and enjoyment of Chatfield State Park is preserved and enhanced
- Creating the ability for storage of an additional 20,600 acre feet of water within Chatfield Reservoir
- Crafting a plan for increased streamflow benefits below Chatfield Reservoir

# USACE Feasibility Study

## By Capitol Representatives

The City and County of Denver and the U.S. Army Corps of Engineers are engaged in a signature 3x3x3 Feasibility Study of the South Platte River, East Harvard Gulch and Weir Gulch in Denver. The Greenway Foundation is pleased to be involved with the study, assisting Denver with federal relations and public outreach.

The focus of the study includes ecosystem restoration improvements and flood control containment opportunities. This collaborative effort will help continue to maximize the reclamation and safety of the River and two of its most significant tributaries.

### The Study is focused on:

- Ecosystem restoration projects
- River flow and health
- Wildlife and riparian habitat
- Flood Control Containment





## Clear Creek Greenway Design Effort

By Randall Navarro, CCGA

In 2013 The Greenway Foundation (TGF) was approached by Clear Creek County to help develop a new non-profit organization, now known as the Clear Creek Greenway Authority (CCGA). The purpose of the CCGA is to help develop and maintain a multi-use greenway throughout the County.

In 2014 the Colorado Department of Transportation (CDOT) agreed to provide Clear Creek County with \$2,000,000 of state funds to design the section of the future Clear Creek Greenway Trail from Hidden Valley to Empire Junction. Clear Creek County matched this commitment from CDOT with an additional \$500,000.

In partnership with the County, the CCGA has contracted with TGF and its design and facilitation team to oversee the initial design of this significant amenity so that the project can create “shovel-ready” projects, the design of which maximize the opportunity to obtain the needed funding to allow this vision to become a reality in the foreseeable future.

## Noble Energy Visioning Grant

By Capitol Representatives

Through the commitment and generosity of a grant from Noble Energy, The Greenway Foundation (TGF) has been able to undertake a baseline study of multi-use recreational trail opportunities along the South Platte River in Weld County. After visits to several communities within Weld County, TGF was able to compile information regarding future opportunities to, one day, create a multi-use trail along several sections of the River within Weld County.

**It has been a longstanding vision of The Greenway Foundation to witness a continuous trail along the South Platte River corridor from Chatfield Reservoir, through the metro Denver area, to the Colorado state line. The support of Noble Energy has allowed The Greenway Foundation to initiate and engage in making this longstanding goal, one day, a reality.**



# North Denver Cornerstone Collaborative

By Barbara Frommell, NDCC

In 2013 Mayor Michael B. Hancock recognized the need to align several redevelopment projects in north Denver including the neighborhoods of Globeville, Elyria, Swansea and River North under one coordinated vision as well as the area now known as the National Western Center. The resulting North Denver Cornerstone Collaborative (NDCC) is a coordinated effort to ensure integrated planning and aligned implementation among these converging projects.

NDCC and The Greenway Foundation are working together, along with numerous additional public and private partners, to restore this section of the South Platte River and the surrounding area to maximize its environmental and recreational potential while improving connections to riverfront open space, and redeveloping the future National Western Center into a center for agriculture, education and Western heritage.

Learn more at [www.denvergov.org/NDCC](http://www.denvergov.org/NDCC)

## Current NDCC projects on or near the River include:

- River North Park design and construction
- Arkins Court Promenade conceptual design
- Heron Pond / Northside Park Master Plan
- National Western Center
- Globeville Landing Improvements
- Two Basin Drainage Projects
- Washington Street Transportation Study
- Brighton Boulevard reconstruction

# Cherry Creek Stewardship Partnership

By Casey Davenhill, CCSP

For over sixteen years, the Cherry Creek Stewardship Partners have been at the center of some of the most innovative stormwater and flood control projects in Colorado. The partners bring students and area residents out to the banks, parks and channel of the Creek to learn about the history and ecology of the Cherry Creek watershed.

In 2015 the partners received the Arapahoe County Partners in Flight Award for their work with the Cherry Creek Valley Historical Society and Arapahoe County Open Space at the 17-Mile House Farm Park. The partners were also recognized as part of an impressive team that were awarded the 2015 Grand Award for Engineering Excellence by the Colorado Association of Stormwater and Floodplain Managers for the Cherry Creek Valley Ecological Park.

The partners have operated under the fiscal sponsorship of The Greenway Foundation since 2008.

Events and outings are posted on their website:

[www.cherry-creek.org](http://www.cherry-creek.org)



# The Water Connection

By Devon Buckels, TWC

The Water Connection (TWC) is an evolution of the South Platte Urban Waters Federal Partnership initiative. TWC leads and supports initiatives and projects that result in positive changes within the South Platte River watershed, either through direct action or by convening partners for shared success. TWC engages with scientists, water managers, businesses and other advocates to build a platform for linking headwaters and urban water issues, growing watershed awareness, and protecting ecological health and water quality.

TWC is transitioning into a partnered arrangement with The Greenway Foundation (TGF's) to enhance and expand TGF's focus on improved water quality conditions within the South Platte River watershed, while also providing the related Urban Waters Federal Partnership program with an established local presence within the South Platte River watershed.

Find out more at [www.thewaterconnection.org](http://www.thewaterconnection.org)



## Clean River Design Challenge

Despite the significant evolution in the health of the South Platte, the reality of trash and other forms of pollution continue to be an ongoing challenge to the River. In response to this reality and thanks to a grant from the Rose Community Foundation's "Innovate for Good" initiative, The Greenway Foundation (TGF), in collaboration with Metropolitan State University (MSU) of Denver's One World One Water (OWOW) Center, created the Clean River Design Challenge. Students at MSU are designing trash-removal devices that can be placed on Cherry Creek in Downtown Denver, where the effectiveness of the device can be observed. This competition will both raise awareness of, and strive towards the development of, solutions to this source of pollution in the South Platte River and its tributaries.

Teams will present their designs to a panel of expert judges from TGF, TWC, Department of Environmental Health, OWOW, the Littleton/Englewood Wastewater Treatment Plant, and the Rose Community Foundation. The top five teams will be chosen to create their devices and then test them April 2016 during TGF's Spring RiverSweep. The winning team will receive a stipend from TGF, thanks again to the Rose Community Foundation's "Innovate for Good" initiative.

The Greenway Foundation and The Water Connection are working together to improve how our River can continue to become cleaner, healthier and, one day, trash-free.





# 2015 Sponsors

Thank you for your  
generosity!

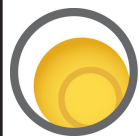

MillerCoors®

noble  
energy



COMCAST



REVERSCO  
PROPERTIES



CDM  
Smith

## INDUSTRY

HFF



Land Title®  
GUARANTEE COMPANY  
— Since 1967 —

DAVID  
HICKS  
LAMPERT

WELLS  
FARGO



in the box®



GRAND AMERICAN INC

BALFOUR  
AT RIVERFRONT PARK



KETTIE  
— BRAND —

ch2m.

SHAW  
CONSTRUCTION

U B E R



HOLLAND PARTNER GROUP

GEJOHNSON  
CONSTRUCTION COMPANY

Family Environmental  
PROFESSIONAL SERVICES  
Menalto Development

east west partners

AE abigail-elise  
INTERIORS

THE SHOEMAKER FAMILY



CHERRY CREEK AREA  
BUSINESS ALLIANCE

Matt Metcalf | The Mile High Home Pro

SIMPLY DENVER  
REAL ESTATE MADE SIMPLE  
www.SimplyDenverHomes.com



McWHINNEY

The Nature  
Conservancy  
Protecting nature. Preserving life.®



PARK HILL  
DEVELOPMENT COMPANY

ROBERT V. AND BILLIE  
MAE BEHRENT ESTATE

THE PIKE COMPANY  
Building Relationships Since 1873

NAI Shames Makovsky



EXPECT THE UNEXPECTED™

REDPEAK



CONSTRUCTION LEADERS

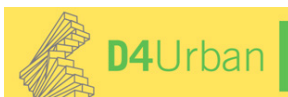

the clinic  
marijuana center



SITE CONSTRUCTION  
MANAGEMENT

NICHOLS PARTNERSHIP

The Floor Club  
Wholesale Only

EXDO  
EVENT CENTER

THE FILLIPINI FAMILY

McGEADY SISNEROS

Xcel Energy®  
RESPONSIBLE BY NATURE®

Alpine Bank

Bindery on Blake  
Creative Office and Retail

URBAN MARKET PARTNERS  
Brokerage • Development • Consulting

8Z  
REAL ESTATE

## 2015 Sponsors

3001 Brighton, LLC  
8z Real Estate  
Abigail-Elise Interiors  
Alpine Bank  
Balfour  
Barr Lake & Milton Reservoir  
Watershed Association  
Bindery on Blake  
Bowland  
Brownstein Hyatt Farber Shreck  
Capitol Representatives  
Castle Pines North Metro District  
CDM Smith  
Centennial Water and Sanitation  
District  
Central Colorado Water  
Conservancy District  
CESCO Linguistic Services  
CH2M  
Charles Stewart Mott Foundation  
Cherfein Joint Venture, LLC  
Cherry Creek Area Business  
Alliance  
City and County of Denver  
Colorado Lottery  
Colorado State University  
Comcast  
D4 Urban  
David Hicks & Lampert  
DaVita  
Denver Properties I LLC  
Denver Water  
Diamond Foods  
Earth Force  
East West Partners  
ECI Site Construction  
Management  
ERO Resources  
EXDO  
Exelis Visual Information  
Solutions  
Falkenberg Foundation  
Family Environmental  
Fidelity Charitable Gift Fund  
Fillipini Family  
First American Title  
First Bank  
Fleet Financial  
Forest City  
Frontier Renewal  
Garden Club of Denver  
GE Johnson Construction  
Grand American  
Grant Thornton, LLP  
Great Divide Brewing  
HDR Engineering, Inc.  
HFF Financial  
Holland Partners  
Holly Medicial Services  
Ibotta  
Industry  
Integer  
Jack in the Box  
JE Dunn  
Kaiser Permanente  
Kirkpatrick Bank  
Land Title  
Landry's  
Larimer Associates  
M.A. Mortenson  
McGeady Sisneros  
McWhinney Real Estate Services,  
Inc  
Menalto, LLC  
Merrick & Company  
Metro Wastewater Reclamation  
District  
Mile High Home Pro  
Mile High United Way  
MillerCoors  
Moniker Foundation  
Moran and Co.  
Muller Engineering Company, Inc.  
NAI Shames Makovsky Realty Co  
National Fish and Wildlife  
Foundation  
Nebraska Community Foundation  
Newmark Grubb Knight Frank  
Nichols Partnership  
Noble Energy  
Otten Johnson  
Oz Architecture

Parkhill/Crawford Development  
PCL Construction  
Penny Harvest - The Young  
Philanthropists Foundation  
Platte River Recovery  
Implementation Program  
Publication Printers  
RedPeak Properties  
Renaissance on the River  
Revesco Properties, LLP  
Riverfront Park Community  
Foundation  
Robert V. and Billie Mae Behrent  
Estate  
Rose Community Foundation  
Roxborough Water & Sanitation  
S.A. Miro  
Schwab Charitable Fund  
Shaw Construction  
Shears Adkins & Rockmore  
Shi Denver, LLC  
Simply Denver LLC  
South Metro Water Supply  
Authority  
South Pearl Merchant Association  
Sports Clips  
St. Charles Town Company  
Staples  
Tetra Tech  
The Clinic  
The Denver Foundation  
The Floor Club  
The Nature Conservancy  
The Pike Company  
The Thomas Edwin Greenbaum  
Foundation  
Trout, Raley, Montañó, Witwer &  
Freeman, P.C.  
Tryba Architects  
Uber  
Urban Drainage and Flood  
Control District  
Urban Market Partners  
Urban Ventures/White  
Construction  
Urban Watersheds, LLC

Venture Architecture  
Wells Fargo  
Wright Water Engineers  
Xcel Energy  
Young Americans Bank

## 2015 In-Kind Support

Arbor Force  
Avid 4 Adventure  
Bohemian Guitars  
Colorado Woodcraft  
Confluence Kayaks  
Dan Iazzo  
Denver Parks & Recreation  
Denver Tramway Heritage Society  
Denver Water  
Downtown Denver Aquarium  
Earth Force  
Einstein's Bagels  
Fishpond  
Fitness in the City  
Health-Ade  
HobNob Events  
Icelandic  
Jameson Whiskey  
JumpBunch  
Kroenke Sports  
Larimer Partners  
Nativ Hotel  
Open Road Snacks  
Perfect Pair  
Raft Masters  
REI  
SoundDown  
Spyder  
Starbucks  
The River Yoga Studio  
Tito's Vodka  
Tony P's  
Urban Drainage and Flood  
Control District  
Westword



## Partners

Capitol Representatives  
Colorado Alliance for  
Environmental Education  
Colorado Department of Parks &  
Wildlife  
Colorado Humanity - River of  
Words  
Colorado Young Leaders  
Denver Department of  
Environmental Health  
Denver Parks and Recreation  
Denver Public Schools  
Denver School of Innovation &  
Sustainable Design  
Earth Force  
Environmental Learning for Kids  
Groundworks Denver  
Joe Shoemaker School  
KIPP Collegiate High School  
Monarch's Welcome Here  
Originative

## RVIP Supporters

City and County of Denver  
Denver Regional Council of  
Governments (TIP)  
Denver Trout Unlimited  
Edmund T. and Eleanor Quick  
Foundation  
El Pomar Foundation  
Gates Family Foundation  
Great Outdoors Colorado  
Helen K. and Arthur E. Johnson  
Foundation  
Johnson Foundation  
State of Colorado (CDPHE,  
Office of the Attorney General,  
DNR, Natural Resource  
Damages Fund/Rocky  
Mountain Arsenal)  
State of Colorado (CDPHE,  
Office of the Attorney General,  
DNR, Natural Resource  
Damages Fund/Shattuck  
Chemical)

State of Colorado (Colorado  
Parks and Wildlife, Fishing Is  
Fun)  
State of Colorado (CWCB, Water  
Supply Reserve Account)  
The Joan and Phill Berger  
Charitable Fund  
United States Environmental  
Protection Agency  
United States Forest Service  
Urban Drainage and Flood  
Control District

## RVIP In-Kind Support and Professional Engagement

Capitol Representatives  
Colorado Department of  
Transportation  
Colorado Hardscapes  
Councilman Chris Nevitt  
Councilman Jolon Clark  
Denver Environmental Health  
DHM Design  
ECI Site Construction  
Management  
ICON Engineering  
Moose Mountain Enterprises  
National Park Service  
The Trust for Public Land

## Individual Donors

Tom & Isabel Abbott  
Ashlie Aids  
Brenda Aids  
Ryan Aids  
Chris Allen  
Catherine Anderson  
Julie Anderson  
Alice Applebaum  
Brent Applebaum  
Neil Atkinson  
Tracy Ballast  
Gail Barry  
Amy Battles  
Tara Beiter-Fluhr  
Lauren Berent  
Ramsey Bernard

Barb Biggs  
Ilene Birge  
Nancy Birge  
Autumn Bjugstad  
Susan Bjugstad  
Kendra Black  
Art Blomberg  
Mark Gregory Bochnak  
Keith Bowen  
Janice Bowland  
Robert Bowland  
Pat Braun  
Elise Brenninkmeyer  
Jonathan Bridges  
Thomas Brinegar  
Charlie Brown & Suzanne Brown  
Jack Brown  
Michele Brown  
Suzanne Brown  
W Scott Butterfield  
Jane Buxbaum  
Valerie Carey  
James Carr  
Wendy Cattanch  
Thomas Cech  
Bar Chadwick  
Barbara Chadwick  
J.J. & Emily Clark  
Jana Clark  
Joe Clark  
Jolon Clark  
Dan Cohen  
Amy Conklin  
Norm Cramer  
Dana Crawford  
Greg Dorolek  
Daniel Eberhart  
David Echter  
Karen Elliott  
Barbara Ells  
Lawrence Elrod  
Patrick Emery  
Emily English  
Stacey Eriksen  
Eden Essex  
Jana Everett  
Bill Falkenberg

Sheri Farabaugh  
Beth Ferguson  
Janice Finch  
Nancy Fitzgerald  
Margaret P. Fleming  
Patricia Flood  
Simon Foot  
Bill Fowler  
Deborah Freeman  
Sigrid H Freese  
Karen George  
Ken Gerdes  
Kate Gillette  
Jeff Grana  
Erik Hagevik  
Linda Hamlin  
Rebekka Harkins  
Megan Harrington  
Robert Harris  
Ron Harris  
Sandy Harris  
Laurie Helmick  
Jennifer Henninger  
Liz Henry  
Alan & Terry Hershey  
Fabby Hillyard  
Martha Hoffman  
Arlene & Roy Hohn  
Stephen Homburger  
Nicole Horst  
Eileen Hyatt  
Nicole Jarman  
Jeff Johnsen  
Jeff Johnsen  
Geoffry Kaatz  
Steven Katich  
Fred Kenny  
Ryan King  
Cheryl Klein  
Julie Koehler  
David L Kurth  
Resa Labossiere  
Tom Lee  
Terry Leprino  
Curt LeRossignol  
Mary Jane Loevlie  
David Martin

Jody Martinez  
 Jana Mathieson  
 Mary McDonald  
 Marilyn Mead  
 Barbara Metzger  
 Brian Midtbo  
 Robbie Monsma  
 John Moran  
 Suzanne Morgan  
 Cynthia Morreale  
 Elise Mulder Osenga  
 Kari Mundscha  
 Brian Murphy  
 Patrick Murphy  
 Tim Murphy  
 Angela Myers  
 Katie Navin  
 Betty Neale  
 Jonathan Novick  
 Brigid O'Connor  
 Phillip O'Neil  
 Melinda ORourke  
 Dean Pearson  
 Gretchen Pearson  
 John Pflaum  
 Mary Ann Pollett  
 Karen Pollock  
 Marge Price  
 John Prosser  
 Diana Pruitt  
 Judi Recht  
 David Reid  
 Darlene Richards  
 Georgetta Richie  
 Richard Roberts  
 Linda Roberts Zinn  
 Elizabeth Roesch  
 Gary Roffe  
 Lesley Roper  
 Paula Sandoval  
 Rhonda Sandquist  
 Rick Sargent  
 Gregg Saunders  
 Bill Seitz  
 Ira Selkowitz  
 Courtney Shoemaker  
 Jay Shoemaker  
 Jeff Shoemaker

Jim Shoemaker  
 Jason Shugart  
 Kevin Singel  
 Sally Sommers  
 Steve Sommers  
 CT Stack  
 Julie Stahl  
 Marilyn Starrett  
 Kip Stastny  
 Matthew & Rebecca Steel  
 Rachel Steel  
 Berkley A. Tague  
 Karen Taleghani  
 David Thorpe  
 John Vickery  
 Peter Wall  
 Nina Wang  
 Tim Watson  
 Tobie Watson  
 Brian Weiler  
 Si Weir  
 Eric Weisman  
 Steve Welchert  
 Bill Wenk  
 Peter West  
 Cora Wheeler  
 Jim Winzenburg  
 James Wogsland  
 Ed Woolman  
 Anne Wormley  
 Tom Young  
 Kathy & Stuart Zimmerman

Thank you  
 for your  
 support!

Thank you for helping me  
 learn more about how to  
 take care of nature.  
 My favorite part was when  
 we built log cabins and when  
 we picked up trash and when  
 we ate lunch. You guys were  
 really nice to us. I think  
 your job is really cool  
 because you get to explore  
 nature and clean the  
 environment. Thank you again.

Sincerely, Eric

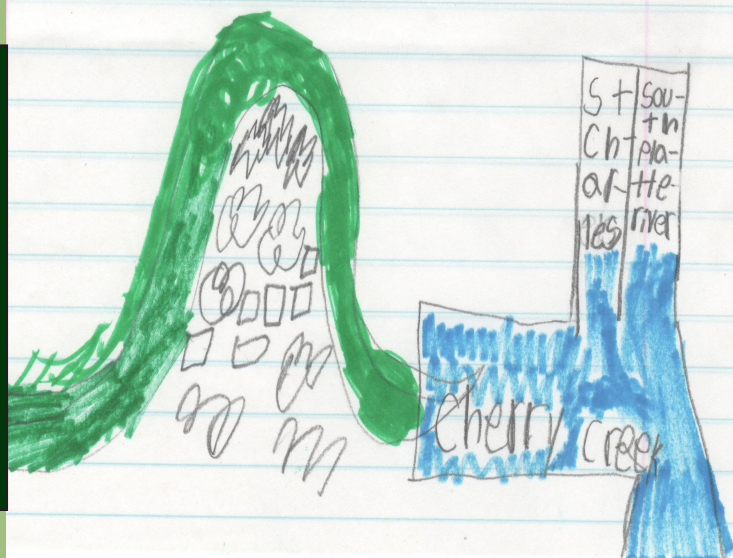



# Greenway Foundation Board & Staff



## 2015 Board of Directors

Kip Stastny, Chairman  
Bar Chadwick, Vice Chairman  
John Moran, Secretary  
Brent Applebaum  
Jon Bridges  
Larry Elrod (Not pictured)  
Fabby Hillyard  
Katie Navin  
Lesley Roper  
Paula Sandoval  
Pete West  
Jason Winkler



## 2015 Staff

Jeff Shoemaker, Executive Director  
Ryan Aids, Development Director  
Autumn Bjugstad, Engagement & Comm. Director  
Rachel Steel, Excursion & Grants Director  
Devon Buckles, The Water Connection Director  
Shelley Jewell, Office Manager  
Lauren Berent, Volunteer & Events Coordinator  
Ramsey Bernard, Youth Programs Coordinator  
Bekky Harkins, Camp Director  
Kate Ronan, Camp Coordinator  
Helen Katich, Educator and Ranger Lead (not pictured)  
Amy May, Educator  
Rachel Pettis, Educator









The Greenway Foundation  
1855 S. Pearl St. Suite 40  
Denver, CO 80210

[www.greenwayfoundation.org](http://www.greenwayfoundation.org)

## 2016 Calendar of Events

|                      |                           |
|----------------------|---------------------------|
| April 30th, 2016     | Spring RiverSweep         |
| May 7th, 2016        | Art on the River          |
| June 25-26th, 2016   | South Platte RiverFest    |
| September 14th, 2016 | Gala on the Bridge        |
| September 15th, 2016 | After Party on the Bridge |
| September 24th, 2016 | Fall RiverSweep           |
| October 8th, 2016    | Family Fishing Day        |



The official printer of The Greenway Foundation

Publication  
Printers corp.